

1 MO Pittsburgh, Cincinnati, Chicago & St. Louis

St. Louis Div (St. Louis)

Operated by TRRA effective 1927-03-01 under lease dated 1927-02-01.

PCC&StL.v1.MO St. Louis Div (St. Louis)
Map# 1_A_SL

1920 Linen (1916 Revision)



VRR.v01.MO-01_A_SL 1916c20p St. Louis Div PL_A132-Lb00g.TIF (A.13.2)

1948 White Line Blueprint (1927 Revision)



VRR.v01.MO-01_SL 1916r27-04c48 St. Louis Div PL_R223-WI400i.tif (R.223)

PCC&StL.v1.MO St. Louis Div (St. Louis)
Map# 1_A_ST

Freight House and tracks, St. Louis

1920 Linen (1916 Revision)



VRR.v01.MO-01_A_ST 1916c20 StL Div - St. Louis Freight House PL_A132-Lb00g.tif (A.13.2)

1948 White Line Blueprint (1927 Revision)



VRR.v01.MO-01_ST 1916r27-06c48 St. Louis Div PL_R223-WI400i.tif (R.223)

1980 1/2 size microfilm

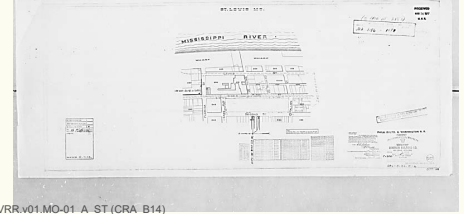

VRR.v01.MO-01_A_ST (CRA_B14)

PCC&StL.v1b.MO St. Louis Div (St. Louis)
Map# 1

buildings in St. Louis leased from TRRA

1924 Linen (1916 Revision)

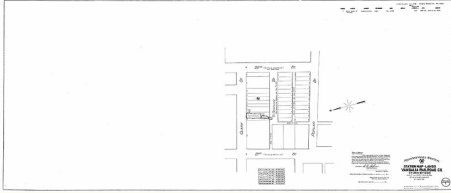

VRR.v01.MO-01_B 1916c24p St. Louis Div Lands PL_A132-Lb00g.TIF (A.13.2)

1948 White Line Blueprint (1925 Revision)

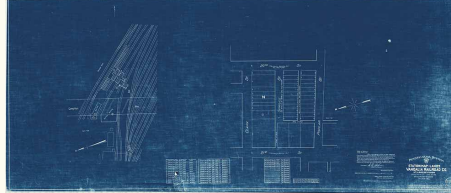

VRR.v01b.MO-01 1916r25c48 St. Louis Div Land PL_R223-WI400i.tif (R.223)

PCC&StL.v1b.MO St. Louis Div (St. Louis)
Map# 1_SL

includes 1c_ST (Track #53 Car Washer leased from TRRA) and 1d_SL near Rankin Coach Yard.

1916 White Line Blueprint

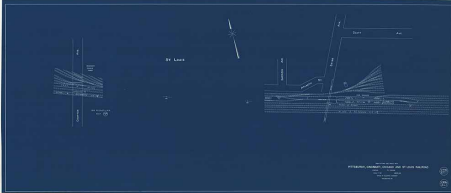

PCC&StL.v01d.MO-01_ST&SL 1916d - St. Louis PL_R223-WI400i.tif (R.223)